

Section of total shoulder replacement

Modular Shoulder Prosthesis, cemented

Modulare - Schulter Prothese, zementiert

Prothèse d'épaule modulaire, cimentée

Indication : The Tipsan cemented shoulder prosthesis has been designed for both total and hemi-arthroplasty of shoulder. The modular components allow for superior tensioning of the soft tissue. Modular design technology provides you with maximum intraoperative flexibility and the patient with maximum postoperative function. The modular components contains the following.

A -) Humeral Stem

- Humeral stems; allow the surgeon for better reconstruction of rotator cuff tuberosity mechanism in difficult fractures and secure fixation of stem in humeral shaft.
- Rotational stability enhanced by lateral and posterior fins.
- Lateral fins allow fixation of tuberosities during hemi-arthroplasty for fracture.
- Modular humeral stem designed for pleno-humeral arthrosis and multifragment proximal humerus fractures.
- Humeral stem designed for cemented fixation in four different diameters (7-9-11.25-12.5 mm) with two different length 130-150 mm.

B -) Modular Heads;

- Four stainless steel humeral head sizes are available with 3 standard heights (standard - 15° protrudet - high) for each diameter, offering comprehensive coverage of size range for soft tissue balancing and ensure accurate fit to glenoid cavity.
- Designed to enhance range of motion.
- Heads can be removed to expose the glenoid surface for future arthroplasty.

C -) Metal-backed glenoid component

- Modular polyethylene liners designed to prevent superior migration.
- Medial fin to enhance glenoid component stability. Provisional glenoid allow intraoperative flexibility in soft tensioning.

Material : Certified Stainless Steel according to ASTM F.138 - ISO 5832/1 for Modular heads and Glenoid shell.

Stem is manufactured either from casting Co.Cr.-alloy according to ASTM F.75 - ISO 5832/4 or Titanium according to ASTM F.136 - ISO 5832/3

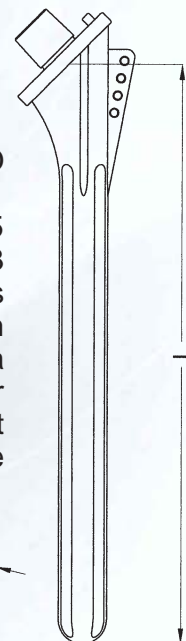
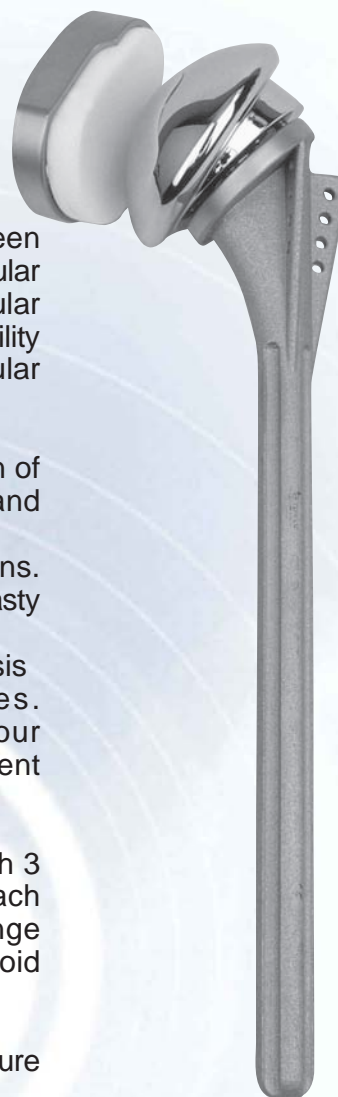



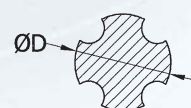

Glenoid insert is manufactured from UHMWPE Ultra Heavy Molecular Weight Polyethylene

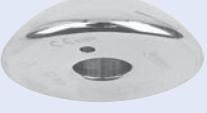

Ref. Number Stainless Steel	Ref. Number Titanium	Ref. Number Co.Cr.-alloy	Size ØD mm	L mm
10235011001	10235012001	10235013001	7.00	130
10235011002	10235012002	10235013002	7.00	150
10235011003	10235012003	10235013003	9.00	130
10235011004	10235012004	10235013004	9.00	150
10235011005	10235012005	10235013005	11.25	130
10235011006	10235012006	10235013006	11.25	150
10235011007	10235012007	10235013007	12.50	130
10235011008	10235011008	10235013008	12.50	150

Section of total shoulder replacement

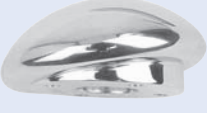
Modular Heads		Size mm	Overview of the Modular Heads
Stainless Steel	Titanium		
Standard			
10235021001	10235022001	40	
10235021002	10235022002	42	
10235021003	10235022003	44	
10235021005	10235022005	47	
15°			
10235051001	10235052001	40	
10235051002	10235052002	42	
10235051003	10235052003	44	
10235051005	10235052005	47	
High			
10235211040	10235212040	40	
10235211042	10235212042	42	
10235211044	10235212044	44	
10235211047	10235212047	47	
Eccentric			
10235031001	10235032001	40	
10235031002	10235032002	42	
10235031003	10235032003	44	
10235031005	10235032005	47	
10°			
10235041001	10235042001	40	
10235041002	10235042002	42	
10235041003	10235042003	44	
10235041005	10235042005	47	

Glenoid Insert



Ref. Number Polyethylene	Size mm
10235077001	Standard

Glenoid Shell



Small Cancellous Screws



Ref. Number Stainless Steel	Ref. Number Titanium	Size mm
10235061001	10235062001	Standard

Ref. Number Stainless Steel	Ref. Number Titanium	Diam. mm	Length mm
10802051008	10802052008	4	24
10802051009	10802052009	4	26
10802051010	10802052010	4	28
10802051011	10802052011	4	30
10802051012	10802052012	4	35
10802051013	10802052013	4	40

Cancellous Screws



Ref. Number Stainless Steel	Ref. Number Titanium	Diam. mm	Thread Length mm	Length mm
10802061002	10802062002	6.5	16	30



**Total Shoulder Prosthesis
Complete Instrumentation Set**

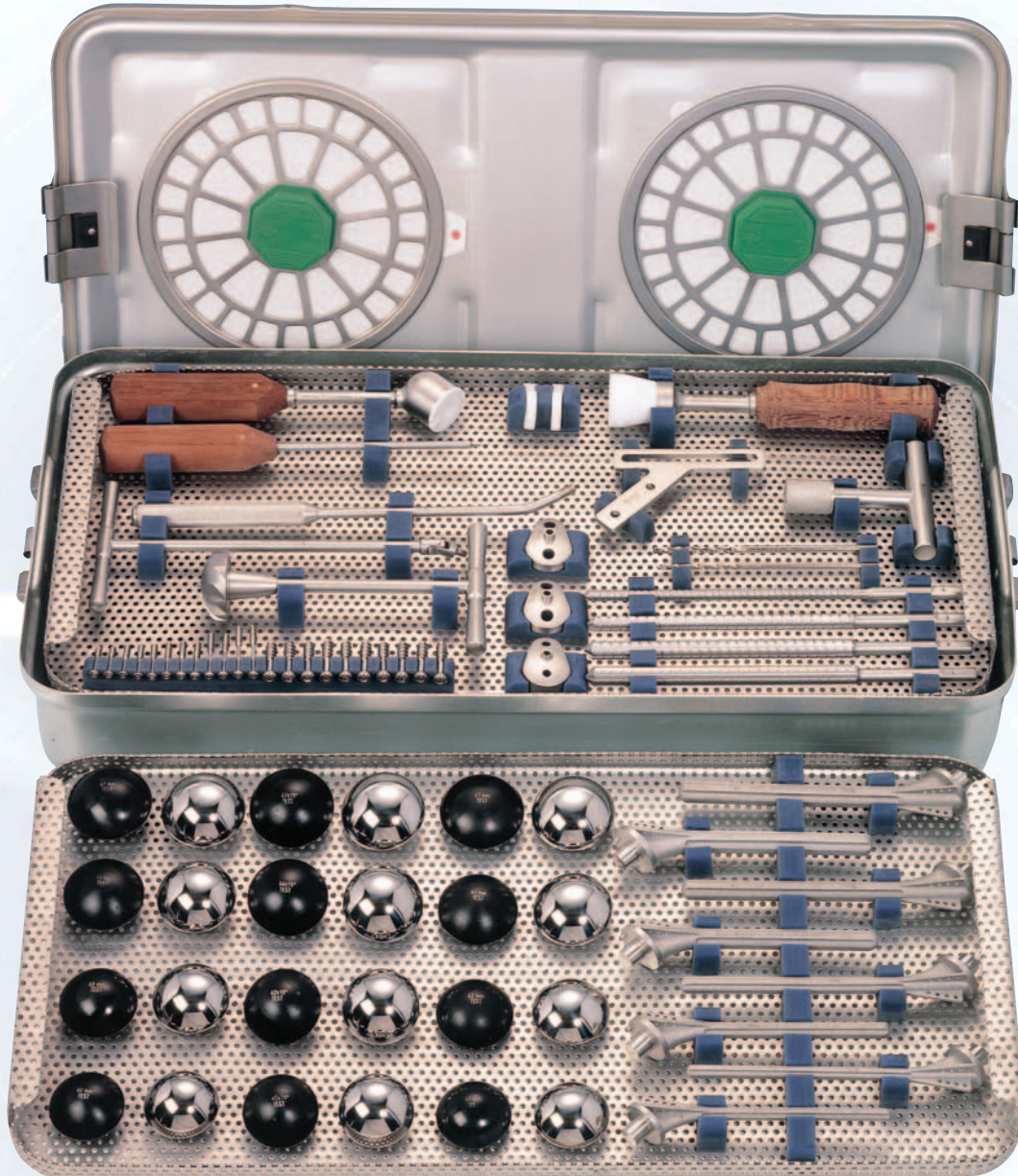

Ref. Number : 18003010001

Ref.Number	Description	Pieces	Ref.Number	Description	Pieces
10607020004	Impactor for Shaft	1	10235007001	Modular Humeral Trial Head Standard	40
10607020003	Femoral Head Impactor	1	10235007002	Modular Humeral Trial Head Standard	42
10606121052	Humeral Head Osteotomy	1	10235007003	Modular Humeral Trial Head Standard	44
10610081001	T-Handle Reamer for Glenoid	1	10235007005	Modular Humeral Trial Head Standard	47
10606121051	Glenoid Centerl Drill Guide	1	10235058001	Modular Humeral Trial Head 15°	40
10604010001	Hexagonal Head Screwdriver	1	10235058002	Modular Humeral Trial Head 15°	42
10610010001	Rasp Ø 7.5	1	10235058003	Modular Humeral Trial Head 15°	44
10610010002	Rasp Ø 9.0	1	10235028005	Modular Humeral Trial Head 15°	47
10610010003	Rasp Ø 11.25	1	10235208040	Modular Humeral Trial Head High	40
10610010004	Rasp Ø 12.5	1	10235208042	Modular Humeral Trial Head High	42
10604071003	T-Handle for Rasp	1	10235208044	Modular Humeral Trial Head High	44
10809011008	Drill Ø 3.5	1	10235208047	Modular Humeral Trial Head High	47
10809011009	Drill Ø 4.5	1	10604011001	Universal Joint Screwdriver	1



Rasps



Ref. Number	Size (ø)
10610010001	7.50
10610010002	9.00
10610010003	11.25
10610010004	12.50

Glenoid Center Drill Guide



Ref. Number
10606121051

Drills



Ref. Number	Size (ø)
10809011008	3.5
10809011009	4.5

Humeral Head Osteotomy Guide



Ref. Number
10606121052

T-Handle for Rasp



Ref. Number
10604071003

Modular Trial Heads	Size mm	Overview of the Trial Heads
Standard		
10235007001	40	
10235007002	42	
10235007003	44	
10235007005	47	
15°		
10235058001	40	
10235058002	42	
10235058003	44	
10235058005	47	
High		
10235208040	40	
10235208042	42	
10235208044	44	
10235208047	47	



Impactor for Shaft

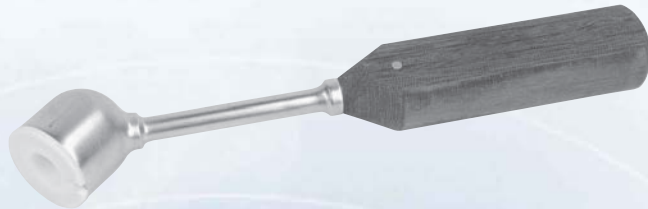

Ref. Number
10607020004

Femoral Head Impactor

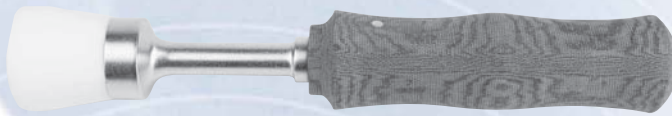

Ref. Number
10607020003

Hexagonal Head Screwdriver

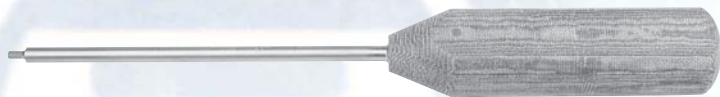

Ref. Number
10604010001

Universal Joint Screwdriver



Ref. Number
10604011001

T-Handle Reamer for Glenoid

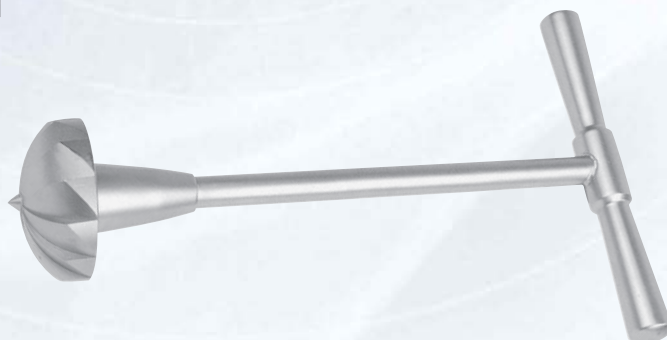

Ref. Number
10610081001



Section of total elbow replacement

Total Elbow Replacement, cemented

Total Ellenbogen Prothese, zementiert

Prothèse de coude totale, cimentée

Indication : The primary indication for joint replacement is pain relief. The Tpsan total elbow replacement has been satisfactorily used in selected cases of elbow joint destruction resulting from arthritis or trauma with associated pain, loss of motion or instability. This device is particularly useful in circumstances of extensive bone loss or gross instability due to trauma, rheumatoid or degenerative arthritis or for revision surgery. Specific contraindications include any condition in which the hand is nonfunctional or if motor control of extremity is severely compromised.

Prior joint infection or osteomyelitis, are contraindications. Excessive scarring of the skin that compromises adequate soft tissue coverage would adversely effect the succes of the prosedure. Total joint replacement should not be considered in a patient anticipating heavy labor, torsional stress or competitive sports where non-implant options may be preferable. This device is designed for use with cement and manufactured with right and left version to fit perfectly to the anatomy and to minimize intramedullary rotation in both the humerus and ulna. The design of metallic hinge pin connector of ulnar and humeral components and ultra-high-molecular-weight polyethylene bushing to prevent metal to metal contact. The removable metallic hinge pin locks in place with a split-locking screw. Dislocation, separation or breakage of the prosthesis has not been reported, once implanted, although the prosthesis is easily disassembled prior surgery.

Material : Certified Stainless Steel according to ASTM F.138 - ISO 5832/1.

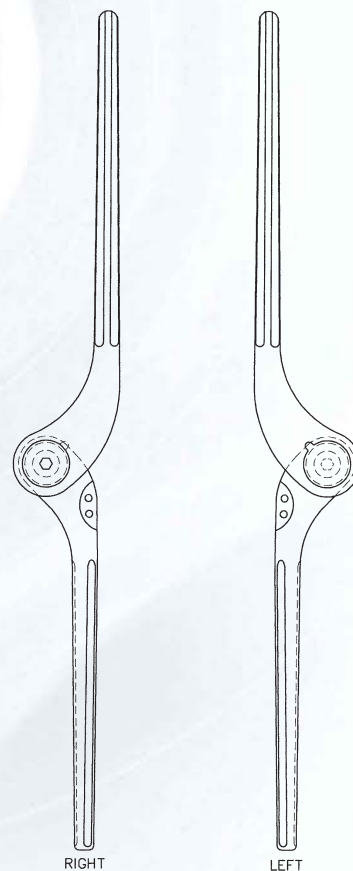

Ref. Number Stainless Steel	Style
10228011001	Right
10228021001	Left